

## NPV DUCO BIDIRECTIONAL PERIMETER SEATED FULL PORT CAVITY FREE DESIGN

SERIES  
200

### FEATURES AND BENEFITS

1. Perimeter seating guarantees bidirectional bubble tight shutoff
2. Elastomer seat is mechanically retained between body halves preventing movement or separation from the body, unlike standard o-ring seated valves
3. Full port cavity free body design prevents dewatering of pulp stock and is ideal in slurries, powders, plastics and other solids handling applications
4. Precision machined body halves serve as scrapper blades, which extend the life of the packing system
5. Two-piece body design simplifies replacement of gate, packing, seat ring and topworks
6. Non-rise stem design is more compact and eliminates a potential safety hazard created by rising stem valves in restricted spaces
7. All NPV valve body castings are of 317 stainless steel
8. All external valve components - stanchions, bolting, bridge, stem, clevis, packing follower and lockout are of stainless steel construction which eliminates external corrosion
9. Precision machining of the stuffing box with the live-loaded packing in conjunction with an additional Viton O-ring provides for a very dependable and adjustable packing system
10. All manual valves are equipped with a stainless steel lockout bar. All automated valves are equipped with a stainless steel mechanical lockout and bar
11. Available in sizes 2" - 30"



### TYPICAL APPLICATIONS INCLUDE

1. All pulp stock applications
2. Refiners for paper machines
3. Refined black liquor, black liquor & stock
4. Lime slurry, fly ash, powders, solids, cement powder and waste treatment slurries

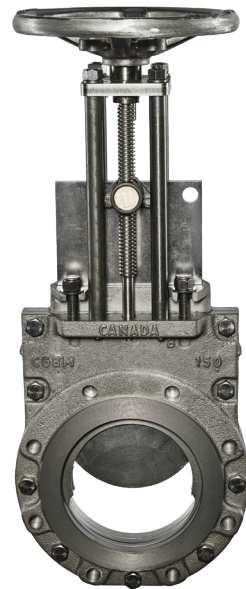
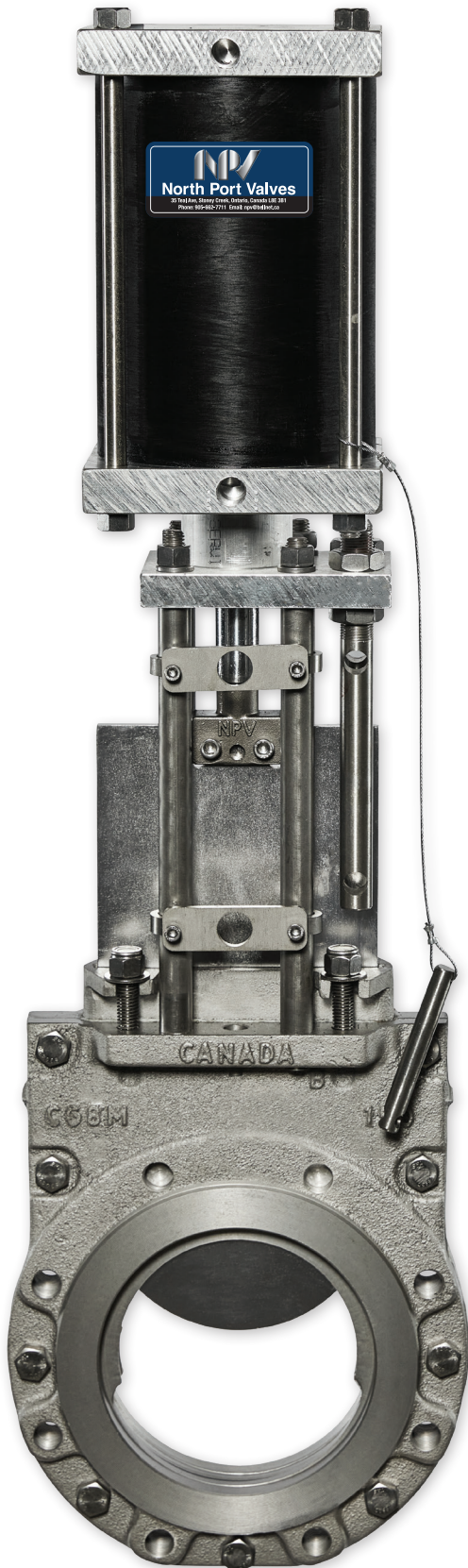

Manual lockout



Full port, perimeter seat

# NPV DUCO BIDIRECTIONAL PERIMETER SEATED VALVE - HANDWHEEL OPERATED

## SERIES 200

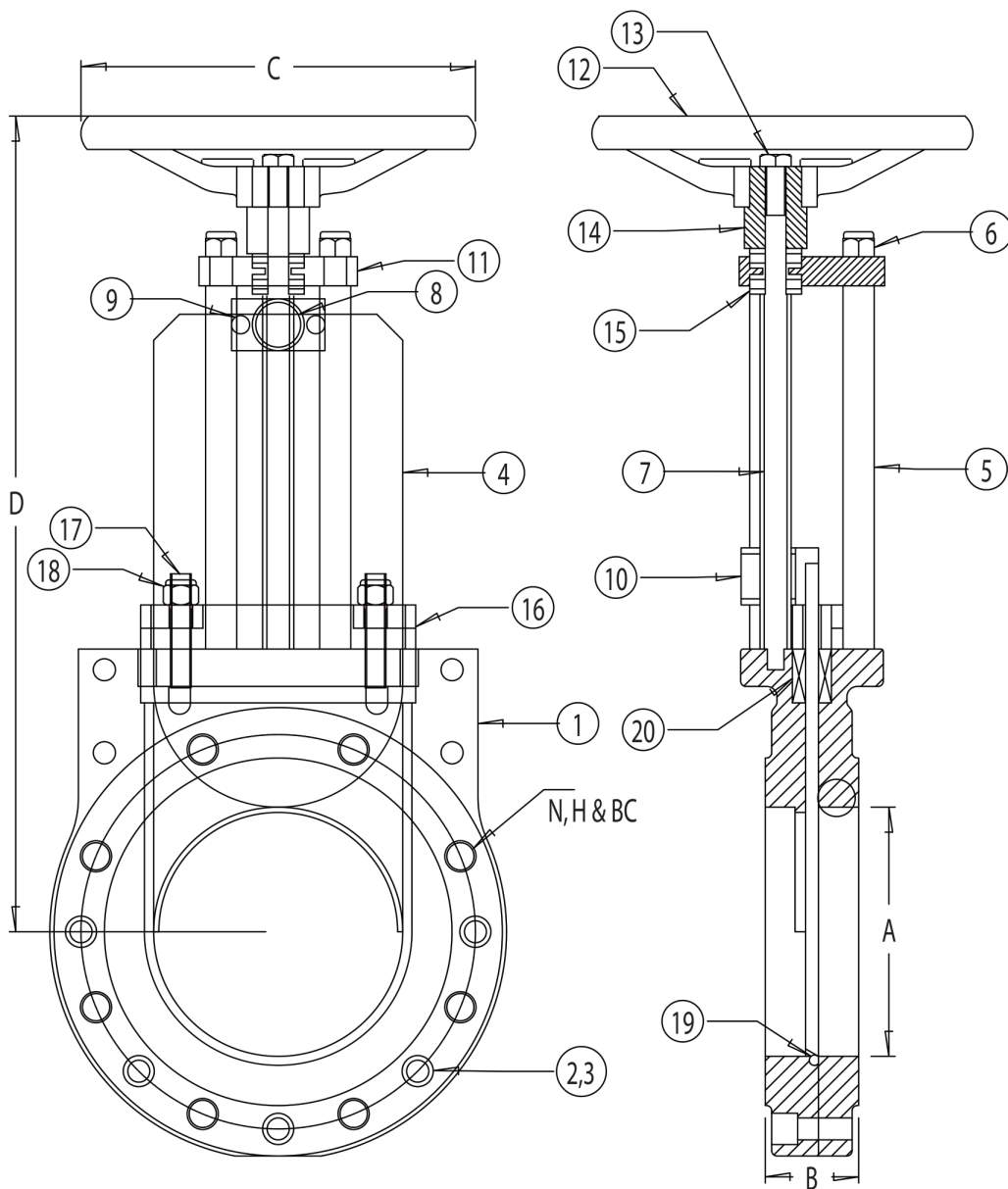

	3"	4"	6"	8"	10"	12"
<b>A</b>	3"	4"	6"	8"	10"	12"
<b>B</b>	2"	2"	2 1/4"	2 3/4"	2 3/4"	3"
<b>N(HOLES)</b>	4	8	8	8	12	12
<b>H(TAP)</b>	5/8" - 11	5/8" - 11	3/4" - 10	3/4" - 10	7/8" - 9	7/8" - 9
<b>BC</b>	6"	7 1/2"	9 1/2"	11 3/4"	14 1/4"	17"
<b>C</b>	7 1/2"	7 1/2"	9"	11 3/4"	11 3/4"	15 3/4"
<b>D</b>	15 1/2"	17"	20 1/4"	25"	30"	33 7/8"

	14"	16"	18"	20"	24"	30"
<b>A</b>	14"	16"	18"	20"	24"	28 5/16"
<b>B</b>	3"	3 1/2"	3 1/2"	4 1/2"	4 1/2"	4 1/2"
<b>N(HOLES)</b>	12	16	16	20	20	28
<b>H(TAP)</b>	1" - 8	1" - 8	1 1/8" - 7	1 1/8" - 7	1 1/4" - 7	1 1/4" - 7
<b>BC</b>	18 3/4"	21 1/4"	22 3/4"	25"	29 1/2"	36"
<b>C</b>	15 3/4"	15 3/4"	20"	20"	23 5/8"	26 3/4"
<b>D</b>	36 7/8"	44 1/2"	48 1/4"	53 7/8"	61"	72 1/2"

	PART NAME	MATERIAL
1	BODY	CG8M (317 S.S.)
2	BODY BOLTS	18.8 S.S.
3	BODY NUTS	18.8 S.S.
4	GATE	316L S.S.
5	STANCHION	303 S.S.
6	NYLOK NUT	18.8 S.S.
7	STEM	303 S.S.
8	COUPLING	303 S.S.
9	COUPLING BOLT	18.8 S.S.
10	STEM NUT	660 BRONZE
11	BRIDGE	304 S.S.
12	HANDWHEEL	ALUMINUM
13	HANDWHEEL BOLT	18.8 S.S.
14	YOKE	303 S.S.
15	BEARINGS	S.S. BALL BEARINGS
16	GLAND	CG8M (317 S.S.)
17	GLAND STUDS	18.8 S.S.
18	GLAND NYLOK NUT	18.8 S.S.
19	O-RING	VITON
20	PACKING	SYNTHETIC (2-12PH)

\*Body & Gate also available in: 254SMO, 2205 Duplex, Titanium, Hastelloy & others upon request

# NPV DUCO BIDIRECTIONAL PERIMETER SEATED VALVE - CYLINDER OPERATED

## SERIES 200

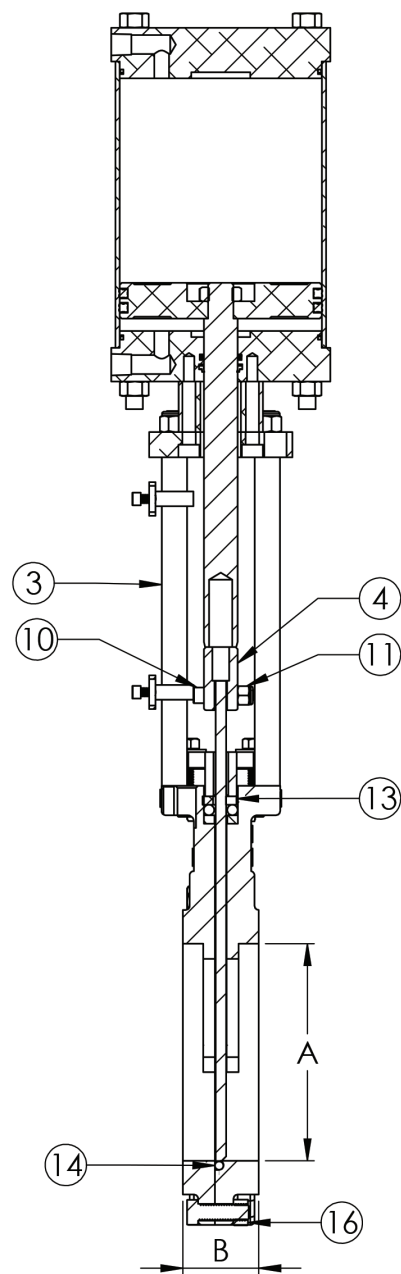
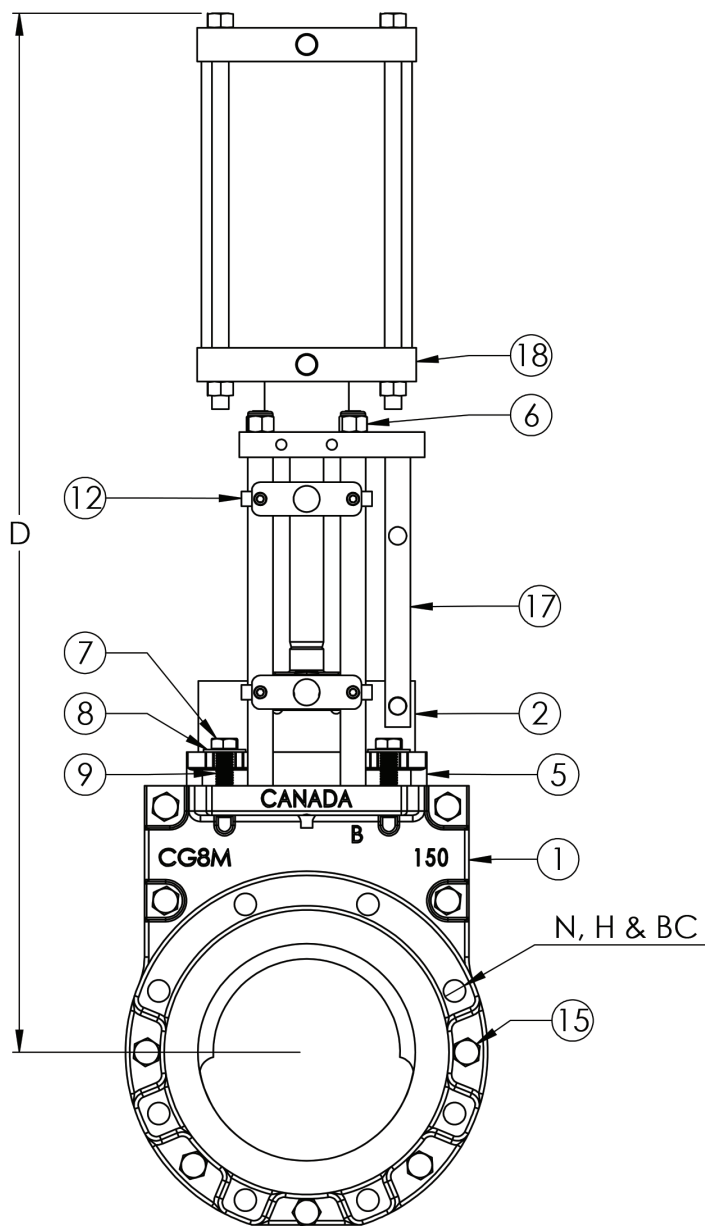

	3"	4"	6"	8"	10"	12"
<b>A</b>	3"	4"	6"	8"	10"	12"
<b>B</b>	2"	2"	2 1/4"	2 3/4"	2 3/4"	3"
<b>N(HOLES)</b>	4	8	8	8	12	12
<b>H(TAP)</b>	5/8" - 11	5/8" - 11	3/4" - 10	3/4" - 10	7/8" - 9	7/8" - 9
<b>BC</b>	6"	7 1/2"	9 1/2"	11 3/4"	14 1/4"	17"
<b>D</b>	20 3/8"	22 1/4"	28 1/4"	34"	40"	49 3/4"
	<b>14"</b>	<b>16"</b>	<b>18"</b>	<b>20"</b>	<b>24"</b>	<b>30"</b>
<b>A</b>	14'	16'	18'	20'	24'	30'
<b>B</b>	3"	3 1/2"	3 1/2"	4 1/2"	4 1/2"	4 1/2"
<b>N(HOLES)</b>	12	16	16	20	20	28
<b>H(TAP)</b>	1" - 8	1" - 8	1 1/8" - 7	1 1/8" - 7	1 1/4" - 7	1 1/4" - 7
<b>BC</b>	18 3/4"	21 1/4"	22 3/4"	25"	29 1/2"	36"
<b>D</b>	54 1/4"	63 3/4"	68 1/2"	75 3/4"	87"	105 1/4"

#	PART NAME	MATERIAL
1	BODY	CG8M (317 S.S.)
2	GATE	316L S.S.
3	STANCHION	303 S.S.
4	COUPLING	CG8M (317 S.S.)
5	GLAND	CG8M (317 S.S.)
6	NYLOCK NUT	18.8 S.S.
7	GLAND NYLOCK NUT	18.8 S.S.
8	GLAND WASHER	18.8 S.S.
9	GLAND STUD	18.8 S.S.
10	COUPLING BOLT	18.8 S.S.
11	NYLOCK NUT	18.8 S.S.
12	LIMIT SWITCH BRACKETS	STAINLESS STEEL
13	PACKING	TEFLON
14	O-RING	VITON
15	HEX BOLT	18.8 S.S.
16	NUT	18.8 S.S.
17	LOCKOUT BAR	303 S.S.
18	AIR CYLINDER ASSEMBLY	N/A